

# Centrifugal planetary mixer for long barrel syringe.

We newly released specific model for long barrel syringe  
which enables to equip with 6oz (170ml) and 12oz (340ml) barrels.

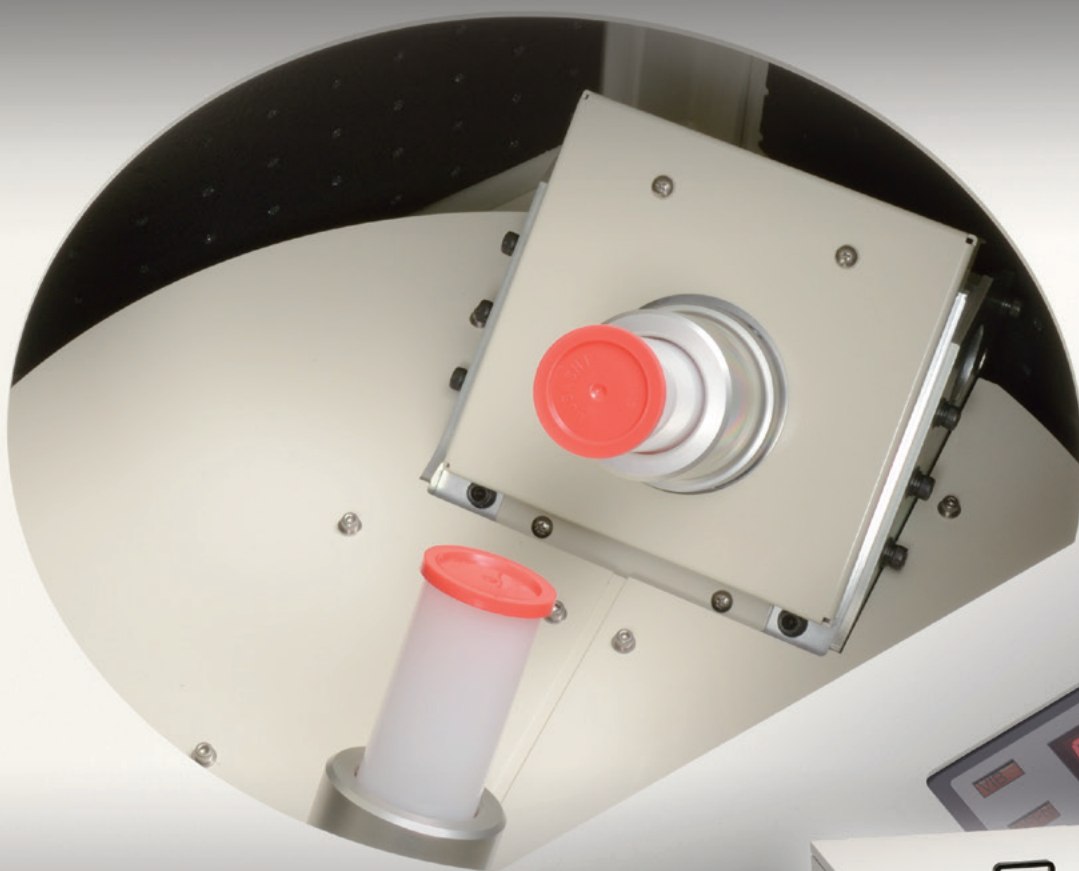

- ▶ Due to individual control system of revolution and rotation speed, it enables to achieve uniform mixing for short time and remove micro fine bubbles.
- ▶ Due to selection of barrels (6oz, 12oz) in following with production level, it enables to enhance productivity and workability.

\* In case of use of 6oz barrel, it requires specific adopter.



Centrifugal Planetary Mixer for Long Barrel Syringe

# SK-BS12

SHASHIN KAGAKU CO., LTD.

[www.shashin-kagaku.co.jp/en/group/pi/](http://www.shashin-kagaku.co.jp/en/group/pi/)

▶ Operational procedure

**Procedure 1**

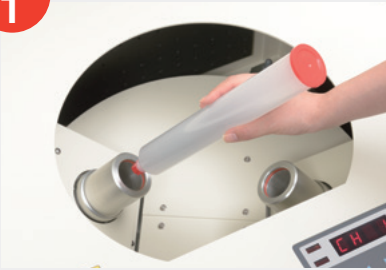

Set long barrel syringe into cup tray

**Procedure 2**



Close top lid after confirming long barrel syringe installed.

**Procedure 3**



Press START ON for control panel. Mixing and degassing jobs will complete for few minutes.

**Centrifugal planetary mixer for long barrel syringe (SK-BS12), it enables to solve various problem under dispensing process.**

▶ It enables to enhance dispensing accuracy due to efficient degassing bubbles inside of syringe.

*Are you facing any problems below?*

- We would like to mix with different specific gravity materials.
- We would like to degas bubbles which generated when shifting from container to container.
- Remaining bubbles inside of syringe unable to dispense evenly.
- We would like to avoid loss of material or break of material composition due to direct contacts of propeller or three roll mills.



**Kakuhunter can correspond and solve for various problems.**

■ Specification

Item	Model	Centrifugal planetary mixer for long barrel syringe <b>SK-BS12</b>
Cup size		6oz, 12oz barrel syringe x 2pcs
Rotation setting		9 level setting
Revolution setting		10 level setting
Setup time		110-300 seconds x 3 steps
Step mode		Continuous 3 steps and 3 different kinds of moving pattern (condition setting) is possible.
Memory channel		User designated setup channel 10CH, fixed data channel 10CH
Power source		Three phase AC200V 50/60HZ
Electric consumption		About 2.0kw
Outer dimension		W646×D662×H730 (mm)
Machine weight		About 225kg

\*Specification and description contents may change without notice

■ Adopted barrel syringe

SEMCO

Musashi Engineering, Inc

Nordson EFD

【Manufacture】

**SHASHIN KAGAKU co., LTD.**

**Product Company**

7-2-1, Noji Higashi, Kusatsu-city, Shiga 525-0058, Japan  
TEL. +81-77-566-1208 FAX. +81-77-565-3506



【Sales representative/ distributors】

Contact and request the latest information on our Revolution-Rotation Motion Mixer & Degassing System

E-mail: [kakuhunter@kakuhunter.com](mailto:kakuhunter@kakuhunter.com)